



User Manual



CARPET CLEANER



Contents

| | |
|--|-----------|
| Overview | 3 |
| Use..... | 4 |
| Package contents/device parts..... | 5 |
| General information..... | 6 |
| Reading and storing the user manual | 6 |
| Explanation of symbols | 6 |
| Safety | 7 |
| Proper use..... | 7 |
| Safety instructions..... | 7 |
| First use..... | 10 |
| Checking the carpet cleaner and package contents | 10 |
| Carpet cleaner assembly | 10 |
| Carpet preparation | 11 |
| Using the carpet cleaner | 11 |
| Filling the water solution tank..... | 11 |
| Cleaning a carpet..... | 13 |
| Tips for carpet cleaning | 13 |
| Emptying the dirty water tank | 14 |
| Cleaning..... | 15 |
| Cleaning the filters | 15 |
| Cleaning the carpet cleaner..... | 16 |
| Storage | 16 |
| Troubleshooting..... | 17 |
| Technical data | 17 |
| Declaration of conformity..... | 17 |
| Disposal..... | 18 |
| Disposing of the packaging | 18 |
| Disposing of the carpet cleaner..... | 18 |

A

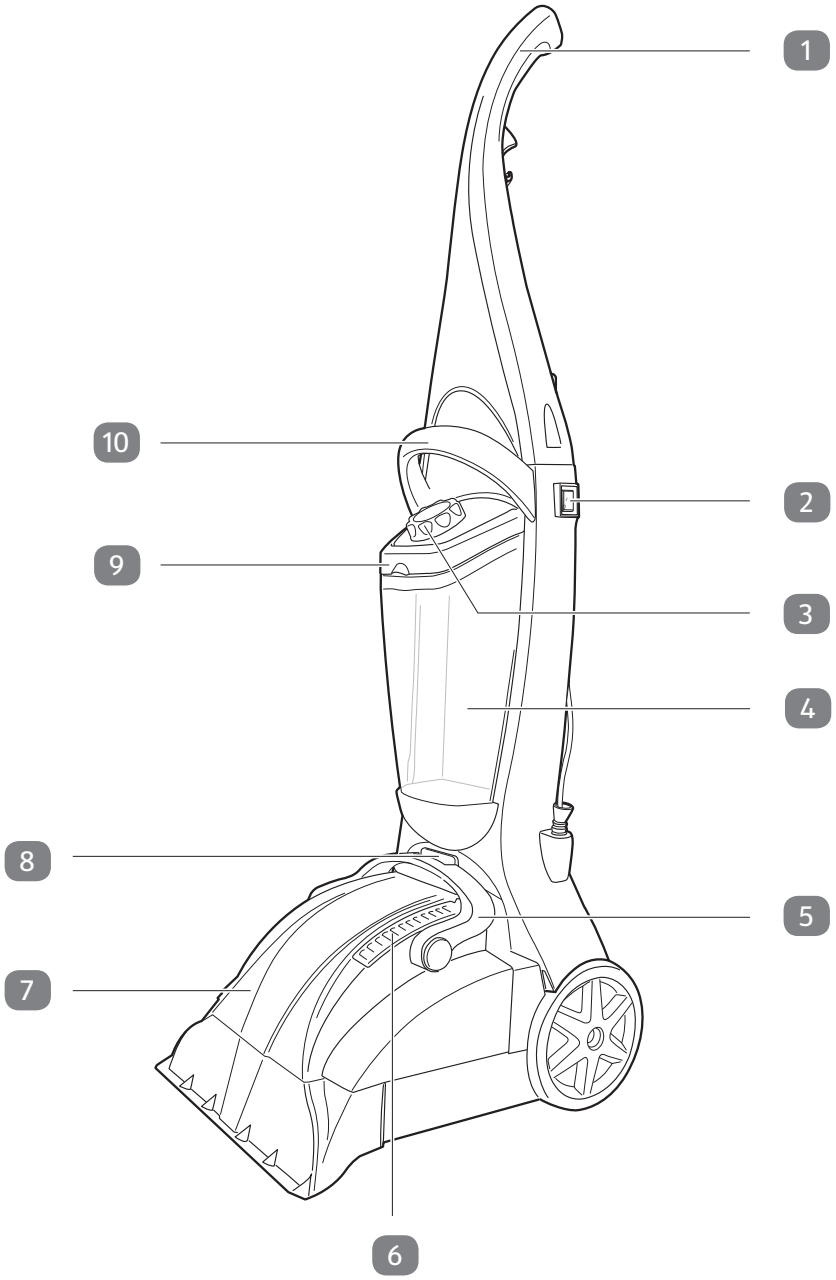

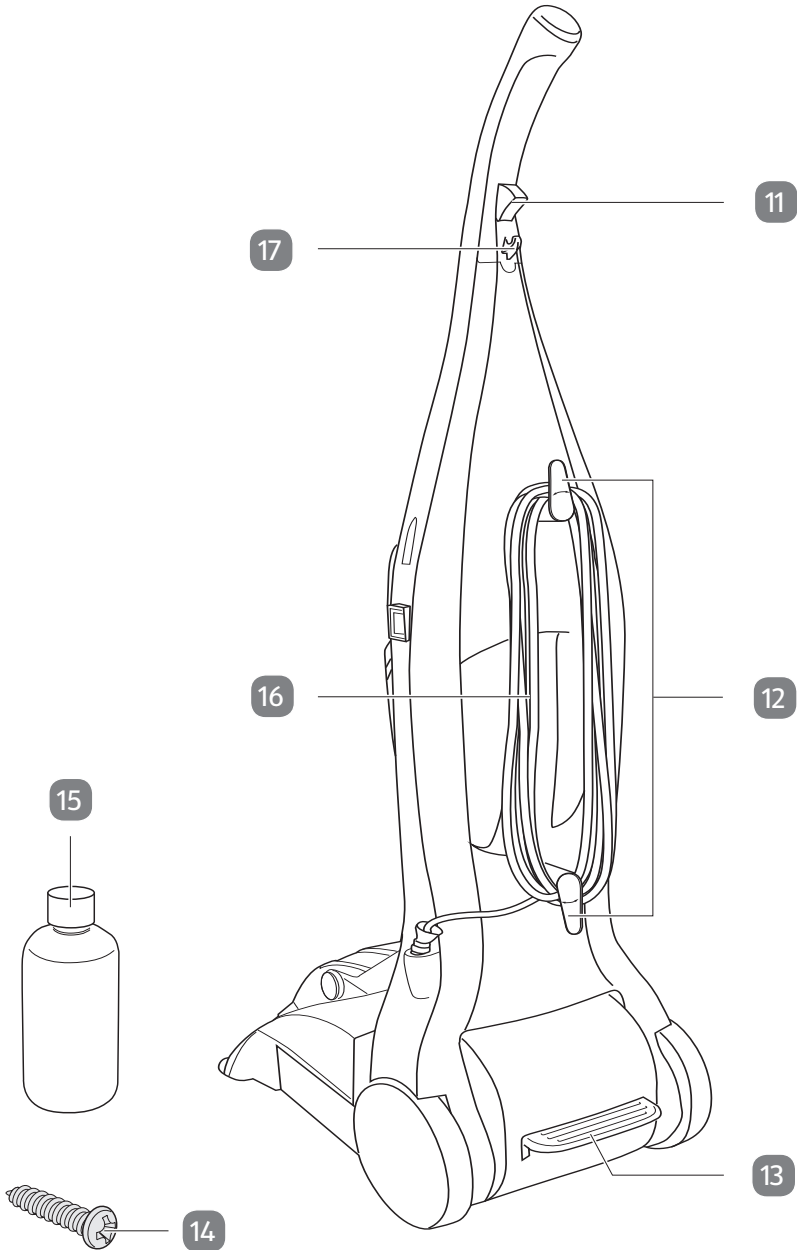

Package contents/device parts

- 1 Handle
- 2 On/off switch
- 3 Water solution tank cap
- 4 Water solution tank
- 5 Dirty water tank handle
- 6 Exhaust filter housing
- 7 Dirty water tank
- 8 Dirty water tank locking latch
- 9 Water solution tank handle
- 10 Carrying handle
- 11 Solution release trigger
- 12 Mains cord hook, 2×
- 13 Handle release pedal
- 14 Crosshead screw, 2×
- 15 Cleaning solution
- 16 Mains cord
- 17 Mains cord clip

General information

Reading and storing the user manual



This user manual accompanies this carpet cleaner and contains important information on setup and use.

Before using the carpet cleaner, read the user manual carefully. This particularly applies to the safety instructions. Failure to do so may result in personal injury or damage to the carpet cleaner.

The user manual is based on the standards and rules in force in the European Union. When abroad, you must also observe country-specific guidelines and laws.

Store the user manual for further use. Make sure to include this user manual when passing the carpet cleaner on to third parties.

Explanation of symbols

The following symbols and signal words are used in this user manual, on the carpet cleaner or on the packaging.



This signal symbol/word designates a hazard with moderate risk, which may result in death or severe injury if not avoided.



This signal symbol/word designates a hazard with low risk, which may result in minor or moderate injury if not avoided.



This signal word warns of possible damage to property.



This symbol provides you with useful additional information on handling and use.



Declaration of Conformity (see chapter "Declaration of Conformity"): Products labelled with this symbol meet all applicable provisions of the European Economic Area.



This carpet cleaner is double insulated: protection class II.

Safety

Proper use

The carpet cleaner is exclusively designed for cleaning carpets. It is only intended for private use and not suitable for commercial purposes.

Only use the carpet cleaner as described in this user manual. Any other use is considered improper and may result in damage to property or persons.

The manufacturer or vendor cannot be held liable for damages or injury incurred through improper or incorrect use.

Safety instructions



Risk of electric shock!

A faulty electrical installation, excessive line voltage, or incorrect operation may result in an electric shock.

- Only connect the carpet cleaner if the line voltage of the socket corresponds to the data on the rating plate.
- Only connect the carpet cleaner to an easily accessible socket so that you can quickly disconnect it from the power supply in the event of a problem.
- Do not use the carpet cleaner if it is damaged or if the mains cord or plug is defective.
- If the supply cord is damaged, it must be replaced by the manufacturer, its service agent, or similarly qualified persons in order to avoid a hazard.
- Do not open the housing; instead, have a qualified professional perform repairs. Contact a qualified workshop for this. Liability and warranty claims are waived in the event of repairs performed by the user, improper connection, or incorrect operation.
- Only parts that comply with the original device data may be used for repairs. This device contains electrical and mechanical parts which are essential for providing protection against sources of danger.

- Do not use the carpet cleaner with an external timer or separate remote control system.
- Do not immerse the carpet cleaner or mains cord in water or other liquids.
- Never touch the mains plug with wet or damp hands.
- Do not pull the mains plug out of the socket by the cord; instead, always pull it out by the plug itself.
- Never move, pull, or carry the carpet cleaner by its mains cord.
- Keep the carpet cleaner and mains cord away from open flames and hot surfaces.
- Lay the mains cord so that it does not pose a tripping hazard.
- Do not kink the mains cord and do not lay it over sharp edges.
- Only use the carpet cleaner indoors. Do not use the carpet cleaner in the rain.
- Never reach to retrieve an electrical device if it has fallen into water. In such a case, immediately disconnect the mains plug.
- Never insert any objects into the housing.
- **WARNING:** the plug must be removed from the socket-outlet before cleaning or maintaining the carpet cleaner.



Danger for children and persons with impaired physical, sensory or mental capacities (e.g. partially disabled persons, older persons with reduced physical and mental capacities), or lack of experience and knowledge (e.g. older children).

- If they are supervised or have been instructed on how to safely use the carpet cleaner and have understood the risks associated with operating it, this carpet cleaner may be used by persons with impaired physical, sensory or mental capacities, or those lacking experience and knowledge. Children may not play with the carpet cleaner. Cleaning and user maintenance must not be performed by children.

-
- Keep children away from the carpet cleaner and mains cord.
 - Do not leave the carpet cleaner unattended while in use.
 - Make sure that children do not play with the plastic wrapping. They may get caught in it when playing and suffocate.

NOTICE!

Risk of damage!

Improper handling of the carpet cleaner may damage it.

- Never expose the carpet cleaner to high temperatures (heaters etc.) or to the effects of the weather (rain etc.).
- Stop using the carpet cleaner if any of the parts are cracked, broken, or deformed. Only replace damaged parts with corresponding original spare parts.
- Do not use the carpet cleaner to suck up any liquid other than the cleaning solution dispensed from it.
- Do not use the carpet cleaner to suck up such wet or damp materials as mud, tile grout, plaster filler, or caulking.
- Do not use the carpet cleaner without the tanks in place.
- Make sure all openings and outlets are free and clear of any blockage that may reduce airflow.
- Keep hair, loose clothing, fingers and other body parts away from the openings and moving parts.
- Do not use the carpet cleaner to suck up flammable or toxic liquids such as gasoline, chlorine bleach or drain cleaner, or use it in areas where they may be present.
- Do not suck up anything that is burning or smoking, such as cigarettes, matches, or hot ashes.

First use

Checking the carpet cleaner and package contents

NOTICE!

Risk of damage!

If you are not cautious when opening the packaging with a sharp knife or other pointed object, you may quickly damage the carpet cleaner.

– For this reason, be very careful when opening it.

1. Take the carpet cleaner out of the packaging.
2. Check to make sure that all parts are included (see **Fig. A** and **B**).
3. Check whether the carpet cleaner or individual parts are damaged. If this is the case, do not use the carpet cleaner. Contact the manufacturer via the service address indicated on the warranty card.

Carpet cleaner assembly



Risk of injury!

Improper handling of the carpet cleaner may cause injury.

– Do not plug the carpet cleaner in until it is fully assembled.
– Do not operate the carpet cleaner without the handle being firmly screwed into place.

1. Set the carpet cleaner in an upright position.
2. Place the handle **1** firmly onto the main body of the carpet cleaner.
3. Make sure that the mains cord clip **17** is on the same side as the mains cord hooks **12**.
4. Drive one crosshead screw **14** into each side of the handle and fasten them snugly.



Do not overtighten the screws, as this could strip the screw holes.

Carpet preparation

NOTICE!

Risk of damage!

Using the carpet cleaner as a dry vacuum will damage it.

- Only use the carpet cleaner with an appropriate carpet cleaning solution.
 1. Remove as much furniture from the room as possible.
 2. Thoroughly vacuum the carpet to be cleaned.
 3. Place a plastic or other protective covering under and around any furniture left in the room.



- In a small area (corner or closet), test the carpet for colour fastness.

4. Dampen a white cloth with the included carpet cleaning solution **15**.
5. Rub the cloth gently over the small test area and check for any colour bleeding.
6. If the cloth remains clean, it should be safe to clean the carpet.

Using the carpet cleaner

Filling the water solution tank



Risk of injury!

Improper handling of the carpet cleaner may cause injury.

- Always unplug the carpet cleaner before filling the water solution tank.
- Avoid prolonged skin contact with cleaning solutions.
- Keep carpet cleaning solution out of the reach of children.
- In case of contact with eyes, rinse immediately with plenty of water and seek medical advice.

NOTICE!

Risk of damage!

Using the carpet cleaner without the water solution tank in place or with a wrong solution may damage the carpet cleaner.

- Always make sure that the water solution tank is properly in place before using the carpet cleaner.
- Do not use any solvents, cleaners with strong acidic or strong alkali formulas, or any type of cleaning solution not specifically for use in carpet cleaning machines.



Only use suitable (low-foaming) carpet cleaning solution. Using incorrect solutions may cause excess foaming, which will prevent the carpet cleaner from working effectively.

1. Unplug the carpet cleaner.
2. While holding on to the water solution tank **4**, lift the water solution tank handle **9** upwards.
3. Tilt the water solution tank away from the carpet cleaner and remove it.
4. Unscrew the water solution tank cap **3** by turning it counterclockwise.
5. Add cleaning solution **15**, making sure to follow the instructions on the bottle.
6. Fill the remainder of the water solution tank with warm tap water (max. 40 °C (104 °F)) and replace the water solution tank cap.
Make sure to not exceed the max fill level.
7. Place the water solution tank back into position by pushing it down and into the carpet cleaner.
8. Push the water solution tank handle down until it clicks, locking into place.

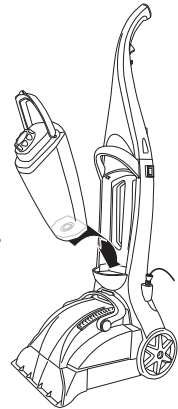

- A bottle of carpet cleaning solution is included. Once this has been used, most commercially available low foaming carpet cleaning solutions may be used. Always read the manufacturer's instructions before use.
- Carpet cleaning solution cannot be ordered from our customer service department.

Cleaning a carpet



- Before cleaning, determine where to start and stop, making sure you will not walk over previously cleaned areas.
- Do not oversaturate the carpet.
- For heavily soiled areas, additional applications may be necessary.

1. Plug the mains cord **16** into an electrical outlet and turn it on by using the on/off switch **2**.
2. Step on the handle release pedal **13** to lower the carpet cleaner into the cleaning position.
3. While pulling the solution release trigger **11**, pull the carpet cleaner in a backwards direction towards you.
4. Release the solution release trigger and push the carpet cleaner forward in the same path to agitate and remove dirty water and solution from the carpet.
5. For heavily soiled areas, repeat as necessary.

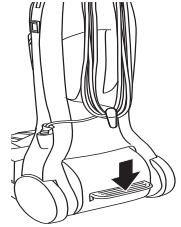

Tips for carpet cleaning

- Use the carrying handle **10** to lift up the carpet cleaner and move it to the desired cleaning location.
- Use a steady, moderate, forward and backward motion.
- Always work from back to front across a room to avoid stepping on wet carpet.
- Do not make the carpet too wet. Use no more than two sets of forward and backward strokes while releasing solution. Always follow with dry strokes; the more the better.
- Wipe any cleaning solution from woodwork and furniture to prevent any damage.
- Allow plenty of time for the carpet to dry and avoid walking on it until it is dry.
- Increased air circulation (open doors, fans, etc.) or the use of a dehumidifier will help the carpet dry thoroughly and prevent the growth of mold or mildew.
- Vacuum the carpet thoroughly before cleaning it and after it has dried.

Emptying the dirty water tank



Risk of injury!

Improper handling of the carpet cleaner may cause injury.

- Always unplug the carpet cleaner before emptying the dirty water tank.



An automatic shut-off device prevents the carpet cleaner from picking up more dirty water than the dirty water tank can hold. You will know the dirty water tank needs to be emptied when:

- the motor sound rises in pitch,
- you do not see dirty solution coming up through the dirty water tank lid,
- or the float inside the dirty water tank has risen to the top of the tank and is visible.

1. Unplug the carpet cleaner.
2. Unlock the dirty water tank **7** by pressing the dirty water tank locking latch **8** and lifting up the dirty water tank handle **5** at the same time (see **Step 1**).
3. Remove the dirty water tank from the carpet cleaner.
4. Open the dirty water tank cap **18** by turning it counterclockwise, so the grip points to the word “unlock” (see **Step 2**).
5. Empty the dirty water tank, replace the dirty water tank cap and turn it to the “lock” position, and place the dirty water tank back into the carpet cleaner (see **Step 3**).
6. Push the dirty water tank handle down until the dirty water tank locking latch clicks into place.

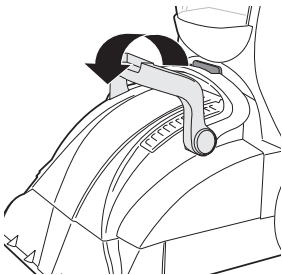

Step 1

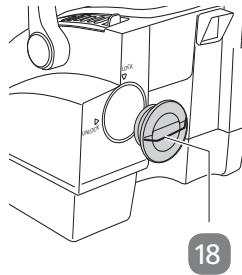

Step 2

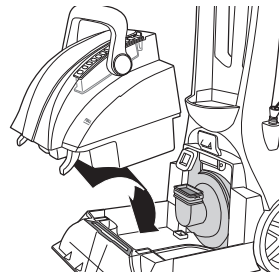

Step 3

Cleaning



CAUTION!

Risk of injury!

Improper handling of the carpet cleaner may cause injury.

- Always unplug the carpet cleaner when not in use, refilling the tanks, cleaning it, or performing maintenance.

NOTICE!

Risk of damage!

Improper handling of the carpet cleaner may result in damage.

- Do not use any aggressive cleaners, brushes with metal or nylon bristles, or sharp or metallic cleaning utensils such as knives, hard scrapers and the like. They could damage the surfaces.
- Never immerse the motor unit in water or any other liquid and do not rinse it under the tap or with a hose.

Cleaning the filters

NOTICE!

Risk of damage!

Improper handling of the carpet cleaner may result in damage.

- Do not clean the filters with any chemicals as this will destroy them.
1. Remove the dirty water tank **7** as described in the chapter “Emptying the dirty water tank.”
 2. Remove the exhaust filter housing **6** from the dirty water tank (see **Step 1**).
 3. Pull out the filter **19** and rinse it with warm water (see **Step 2**).
Allow it to dry thoroughly when storing the carpet cleaner.
 4. Replace the filter and put the exhaust filter housing back into the dirty water tank.

5. With the dirty water tank still removed, pull out the motor filter **20** and rinse it with warm water (see **Step 3**).
Allow it to dry thoroughly when storing the carpet cleaner.
6. Replace the filter and put the dirty water tank back into the carpet cleaner as described in the chapter “Emptying the dirty water tank.”

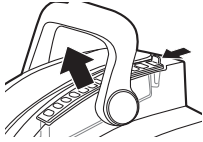

Step 1

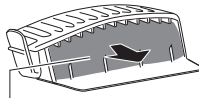

19 **Step 2**

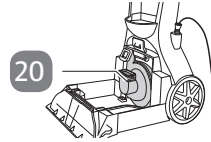

20 **Step 3**

Cleaning the carpet cleaner

1. Unplug the carpet cleaner.
2. Make sure the water solution tank **4** and the dirty water tank **7** are empty (see chapter “Emptying the dirty water tank”).
3. Use a soft damp cloth to wipe off the carpet cleaner and accessories. Then let all parts dry completely.

Storage

NOTICE!

Risk of damage!

Mineral deposits and mildew can form when cleaning solution and/or water is left in the tanks, affecting the performance of the carpet cleaner.

- Do not store the carpet cleaner with cleaning solution left in the water solution tank or dirty water left in the dirty water tank.

All parts must be completely dry before being stored.

- Always store the carpet cleaner in a dry area.
- Protect the carpet cleaner from direct sunlight.
- Store the carpet cleaner so that it is not accessible to children.

Troubleshooting

| Problem | Solution |
|---|---|
| Carpet cleaner will not run. | <ul style="list-style-type: none"> - Make sure the carpet cleaner is plugged in. - Check the fuse or breaker. |
| Not enough suction during floor cleaning. | <ul style="list-style-type: none"> - Empty the dirty water tank; it may be full and the automatic shut-off engaged. - Make sure the dirty water tank is properly installed. |
| Cleaning solution will not dispense. | <ul style="list-style-type: none"> - Make sure the water solution tank is fully inserted and securely in place. - Refill the water solution tank if it is empty. |

Technical data

| | |
|-------------------------------|------------------------------|
| Model: | VC9389 |
| Power supply: | 230 V ~ 50 Hz |
| Output: | 600 W |
| Protection class: | IPX4 |
| Water solution tank capacity: | 1.8 L – max. capacity 2.8 L |
| Dirty water tank capacity: | 1.75 L – max. capacity 2.4 L |
| Product code: | 10953 |

Declaration of conformity



The EU declaration of conformity can be requested from the address specified on the enclosed warranty card.

Disposal

Disposing of the packaging



Sort the packaging before you dispose of it. Dispose of paperboard and cardboard with the recycled paper service and wrappings with the appropriate collection service.

Disposing of the carpet cleaner

(Applicable in the European Union and other European countries with separate collection systems of recyclable materials)



Old appliances may not be disposed of in the household waste!

Should the carpet cleaner no longer be capable of being used at some point in time, **dispose of it in accordance with the regulations in force in your city or county.** This ensures that old appliances are recycled in a

professional manner and also rules out negative consequences for the environment. For this reason, electrical equipment is marked with the symbol shown here.



Great care has gone into the manufacture of this product and it should therefore provide you with years of good service when used properly. In the event of product failure within its intended use over the course of the first 3 years after date of purchase, we will remedy the problem as quickly as possible once it has been brought to our attention. In the unlikely event of such an occurrence, or if you require any information about the product, please contact us via our helpline support services, details of which are to be found both in this manual and on the product itself.



PRODUCED IN CHINA FOR:

ALDI STORES LTD. PO BOX 26, ATHERSTONE
WARWICKSHIRE, CV9 2SH.

ALDI STORES (IRELAND) LTD.
PO BOX 726, NAAS, CO. KILDARE.
Visit us at www.aldi.com

AFTER SALES SUPPORT

10953



GB 01909 517672

IE 012 475 437



keyocr@jtmcontracts.com

MODEL:
VC9389

03/2019

3
YEAR
WARRANTY